

PROOM Sync. Installation Guide



Installation

PROOM Sync is available for Windows 7, Windows 8.1 and Windows 10 (32-bit and 64-bit) operating systems. To find out which operating system your computer is running, go to Start > Control Panel > All Control Panel Items > System.

Now, you may download PROOM Sync.

<https://www.procad.de/en/products/proom/>



The Installation Wizard will be launched. Once the installation is complete, PROOM Sync Setup Wizard will pop up. You can always change your settings in PROOM Sync later on.

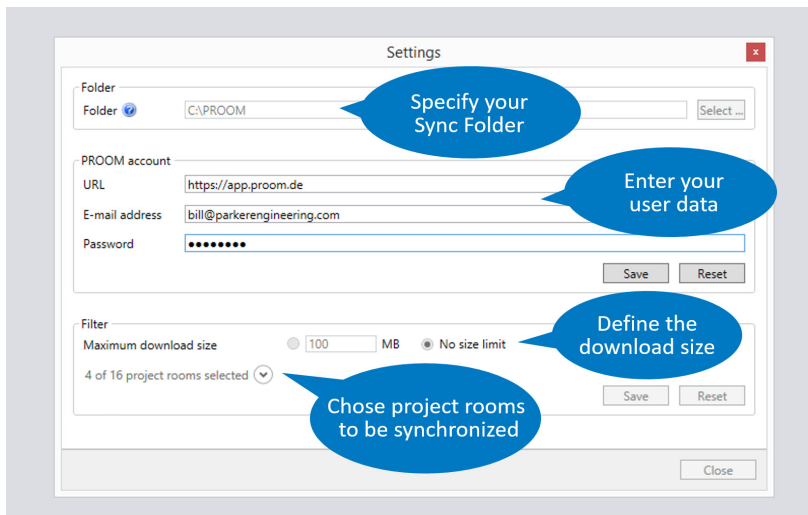

Update Instructions

With every start-up PROOM Sync will automatically check if new versions of the software are available. New versions can be installed directly from PROOM Sync.

